



# **MANUAL**

## **TEC-DC9**

**Series (Shown)**

## **AB-10**

**Series (Not Shown)**



***There are no excuses for unsafe handling of firearms, only regrets.***

**Never accept or pick up a firearm without removing the magazine, checking the chamber to assure it is empty, and placing the weapon on safe.**

**Always make sure the muzzle is pointed in a safe direction at all times.**

**Never store firearms and ammunition together. Keep them locked up and away from children or any incapacitated persons.**

**Never attempt when carrying a loaded firearm to climb a wall or any obstacle.**

**Never touch the trigger when working the operating handle.**

**Never tamper with the magazine or use magazines not manufactured by INTRATEC.**

**Never alter any components of your firearm.**

**Never take medications, drugs or alcohol when handling firearms.**

**Never use old or reloaded ammunition; use only recommended ammunition.**

**Never load or unload a firearm without assuring the muzzle is pointed in a safe direction.**

**Never keep a loaded firearm in the home, car, boat, or R.V.**

**Never load a firearm except immediately before shooting.**

**Never handle firearms without proper shooting glasses and ear protection.**

**Never place finger on trigger until ready to fire.**

**Never place hands near the muzzle at any time.**

**Never point a firearm at anything you do not intend to shoot.**

**When firing, make sure your "audience" is ALWAYS 5 feet in back of you and wearing proper ear and eye protection.**

**Never shoot at any water surface or any surface where a ricochet can occur.**

**Never shoot until you are sure of your backstop and what lies beyond it.**

**If the gun does not discharge after pulling trigger, do not change its down range position for at least 30 second; you could be having a "hang fire".**

**All malfunctions must be reported immediately and the use of the firearm discontinued until the problem is corrected by the manufacturer.**

**If you do not understand how to operate any of our products or have any questions about their safe handling, please write to us.**

**Note: Firearms, like many other products, are inherently dangerous, and incorrect handling increases the risk of injury to those around them.**

# RECOMMENDED AMMUNITION FOR ALL MODEL PISTOLS

9mm Luger/Parabellum, full metal jacket bullets:

Federal  
Federal "American Eagle"  
Winchester  
Remington

Please...NEVER use re-loaded ammunition!

Your firearm was designed to fire ONLY factory, full metal jacketed (FMJ or MC) ammunition.

INTRATEC cannot recommend any brand of ammo we have not tested extensively at the factory.

**Do not use any cases with a wall thickness of less than .027, also do not use any reloaded ammunition regardless of wall thickness.**

The reason behind this recommendation is that, in all blowback designed firearms, as a round is fired, the case begins to move rearward as the expanding gases are at their highest pressures. At this moment, a small back portion of the case wall is not supported by the chamber walls, therefore, making wall thickness a critical factor.

## WARNING

Discharging firearms in poorly ventilated areas, cleaning firearms, or handling ammunition may result in exposure to lead and other substances known to cause birth defects, reproductive harm, and other serious physical injury. Have adequate ventilation at all times. Wash hands thoroughly after exposure.

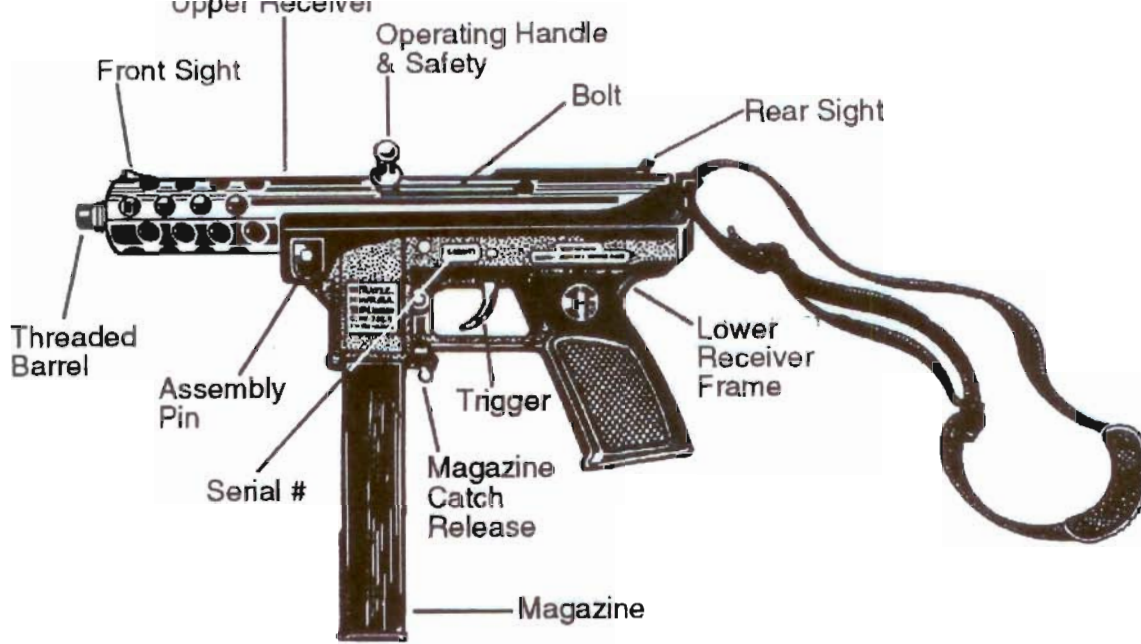

## INTRODUCTION

These firearms are designed and manufactured in the United States. Extensive research and computer assisted development has been incorporated into this model. Thanks to the advanced design and modern high speed manufacturing techniques, we can assure low cost, without compromising quality in materials and workmanship.

## DESCRIPTION

These models are semi-automatic pistols, which operate by elementary blowback and closed bolt position. The sights are standard open combat sights. The push-in type safety securely locks the firing pin from traveling forward. It can be fired by one or two hands from most shooting positions.

### TECHNICAL SPECIFICATIONS

|                           | *TEC-DC9                | +TEC-DC9M     | AB-10         |
|---------------------------|-------------------------|---------------|---------------|
| Ammunition                | 9mm Luger or Parabellum |               |               |
| Weight unloaded           | 55 oz. **               | 44 oz. ++     | 45 OZ.        |
| Weight of loaded magazine | 22 oz.                  | 12 oz.        | 22 oz.        |
| Length                    | 12 1/2 in.              | 10 1/2 in.    | 10 1/2 in.    |
| Barrel Length             | 5 in.                   | 3 in.         | 2 3/4 in.     |
| Sight radius              | 10 in.                  | 7 3/4 in.     | 7 3/4 in.     |
| Muzzle velocity           | 1200-1400 fps           | 1100-1300 fps | 1100-1300 fps |
| Practical range, off hand | 50 yds.                 | 25 yds.       | 20 yds.       |
| with rest                 | 100 yds.                | 50 yds.       | 40 yds.       |
| Magazine capacity         | 32 rds.                 | 20 rds.       | 32 rds.       |

\*TEC-DC9K & TEC-DC9S SAME SPECS AS TEC-DC9

+TEC-DC9MK & TEC-DC9MS SAME SPECS AS TEC-DC9M

\*\*DC9K/51 OZ. - DC93/52 OZ.

++DC9MK/45 OZ. - DC9MS/46 OZ.

## CONSTRUCTION

The tube-shaped upper receiver houses the barrel and bolt. The forward end is provided with **\*ventilation holes** for cooling of the barrel and improving sustained fire. The barrel of the AB-10 Series tends to get extremely hot due to it not having ventilation holes. The left side of the upper receiver has a slot for the operating handle.

The high-impact frame forms the magazine well and grip. It also houses the trigger mechanism. The frame is attached to the upper receiver by an assembly pin on the front of the lower receiver.

The bolt is recessed at the back to house the striker and firing pin.

## FUNCTIONING

When ready to fire the bolt is in a closed position, the striker and firing pin are held in the rear position by the sear. When the trigger is pressed the disconnecter pulls down the sear, which disengages the striker. The striker carries the firing pin forward, igniting the chambered round.

Simultaneously, as the gas pressure accelerates the bullet, the case pushes the bolt rearwards. Due to the much greater mass of the bolt compared with the bullet, the bolt has only moved about 1/16" when the bullet leaves the barrel. On its way rearwards, the bolt, by the combined actions of the extractor and ejector, throws out the empty case. At the rear, the bolt is stopped by the increasing force of the recoil spring and driven forward again. The bolt, on its way forward catches the top round in the magazine and feeds it into the chamber, and then the firearm is ready to fire once again. The complete cycle will take .08 seconds.

## INSTRUCTIONS FOR USE

Before proceeding to use this weapon a word of caution is in order. The pistol is as safe to handle and use as we can make it, but there is no foolproof firearm. **Be sure that the muzzle is pointing in a safe direction at all times, whether the gun is loaded or not. Make safe gun handling a habit. Do not attempt to load and fire this weapon until you are thoroughly familiar with all its safety features and fully understand the operation of this firearm.**

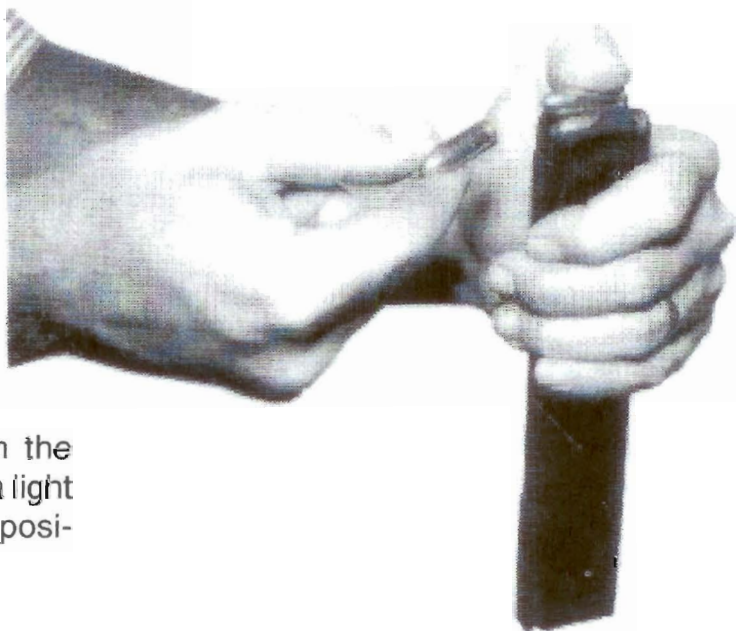

## LOADING THE MAGAZINE

Press the cartridges down between the magazine lips. As with all magazines, a light tap on the back ensures a uniform positioning of the cartridges.

\*Not found on TEC-DC9M, TEC-DC9MS, TEC-DC9MK, AB-10 & AB-10S/S  
(WARRANTY HONORED ON MANUFACTURER'S MAGAZINE USE ONLY.)

# ★ ★ VERY IMPORTANT ★ ★



Operating Handle  
"push" in for safety

## SAFETY

First, make sure firearm is unloaded. Pull back on operating handle to cock the firearm, and then release operating handle to spring back to original position. Now you can push the operating handle completely flush in towards the frame, which blocks the firing pin from traveling forward - Creating the "safe position".

**NOTE:** The safety will not engage if the striker and firing pin are in the forward position. The bolt can not be cocked in the safe position.

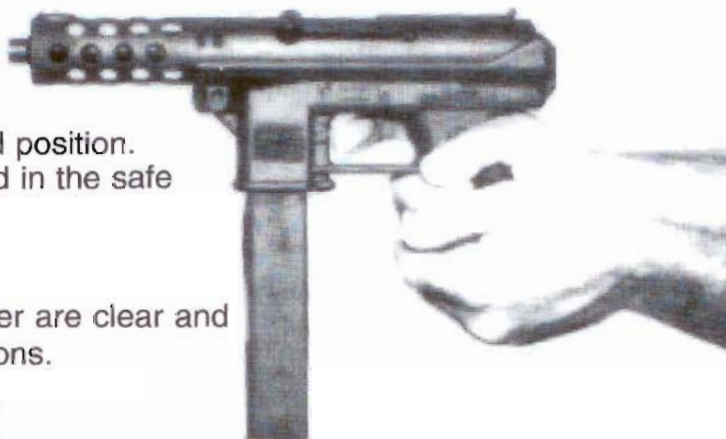

## BEFORE LOADING

Be sure barrel and chamber are clear and free of grease or obstructions.

## LOADING THE FIREARM

With bolt forward and operating handle in the "safe position" insert a loaded magazine into magazine well, finger away from trigger, **(TEST) Pull down on magazine to make sure it has locked in place.**

Make sure to pull out fully the operating handle from the "safe position", and then pull the handle all the way to the rear, so the striker becomes engaged by the sear. Release (LET GO) the operating handle, allowing bolt to spring forward and chamber the first round.

**Warning:** During this operation keep fingers away from trigger and be sure the muzzle is pointing in a safe direction.



## WARNING

**AFTER MAGAZINE IS INSERTED, IT MUST BE PULLED DOWN TO ASSURE IT IS LOCKED IN PLACE FOR GUN TO FUNCTION PROPERLY.**

The firearm is now ready to fire. Keep finger away from trigger until you are ready to fire.

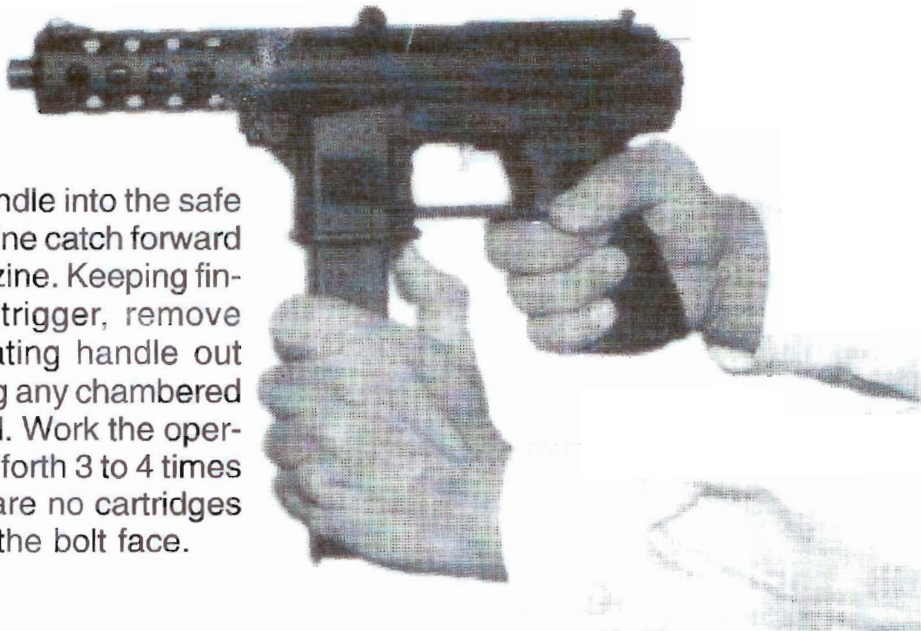

**UNLOADING**

Push the operating handle into the safe position. Press magazine catch forward and remove the magazine. Keeping fingers away from the trigger, remove safety and pull operating handle out and to the rear, causing any chambered rounds to be extracted. Work the operating handle back and forth 3 to 4 times and check that there are no cartridges in the chamber or on the bolt face.

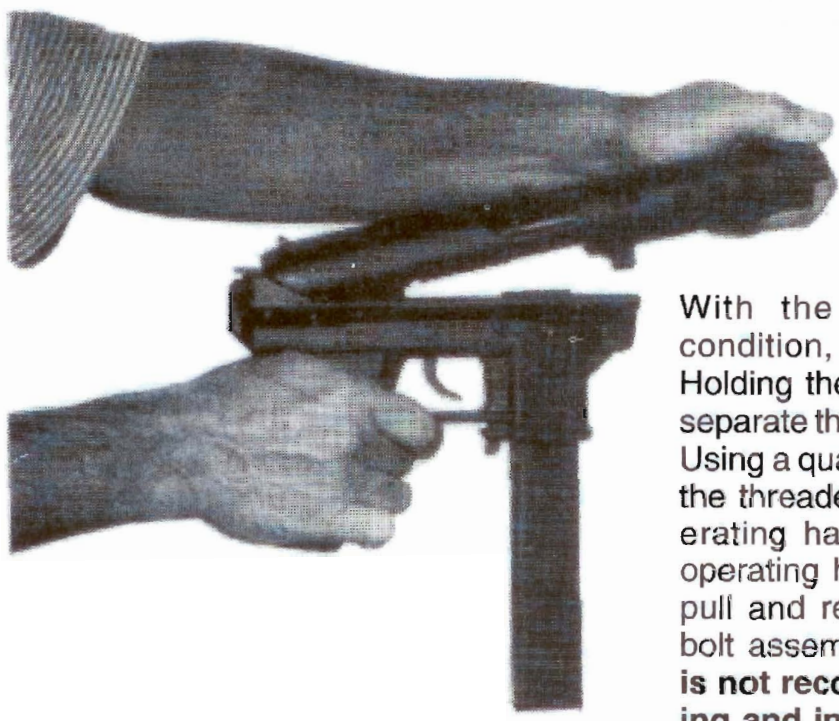

**DISASSEMBLY**

With the firearm in the unloaded condition, push out the assembly pin. Holding the upper receiver firmly, lift and separate the upper from the lower receiver. Using a quarter coin, unscrew and remove the threaded rear disk cap. Slide the operating handle all the way back to the operating handle disassembly notch and pull and remove operating handle from bolt assembly. **Additional disassembly is not recommended for normal cleaning and inspection.**

**REASSEMBLY**

Assemble in reverse order. Note: firing pin in bolt must be pulled to the rear and locked in place by pushing in safety before bedding upper receiver to lower receiver. Also lightly grease rear buffer to prevent binding before assembly of threaded rear disk cap.

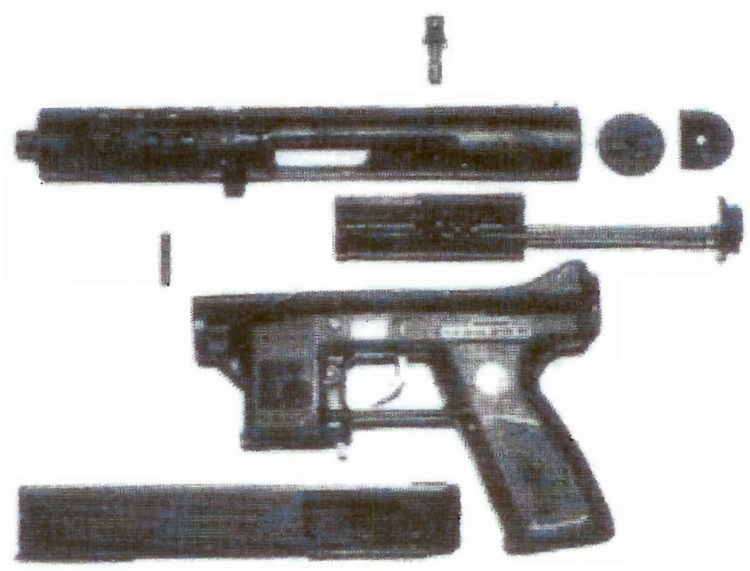

# SHOOTING

During this operation, keep finger away from the trigger until you are ready to fire. The illustrations below show four recommended positions found practical under extensive field tests.

**WARNING:** If while firing, a weak or softer than Normal Report is heard, **stop immediately**, unload and check for barrel obstruction. **Never attempt to shoot out an obstruction, serious injury may result.** Your Gun cannot be fired until the barrel obstruction is removed. If you cannot remove the obstruction, please return at once to the factory for safe removal.



For short range fast action



Weaver-stance for distance up to 50 yds.



Prone with magazine rest at ranges up to 150 yds.



Hipfire at shortest range.

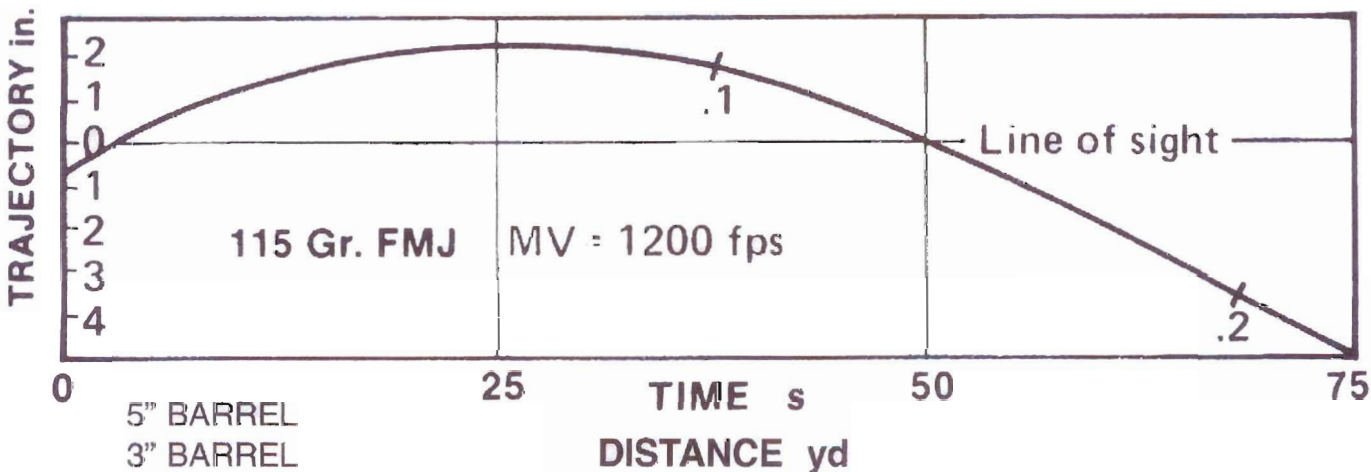



## Malfunctioning

Stoppages are almost invariably caused by the ammunition or its maintenance condition. Irregular or very short ejection indicates underpowered cartridges. Unreliable feeding indicates damaged magazine lips or unsuitably shaped bullets. You should also avoid unnecessary dry fire, which causes the bolt face and / or the firing pin to be damaged.

**General rule:** Remove the magazine

Remove misfired or jammed cartridge

Place the firearm on safe

If any of the above problems are not solved by cleaning, immediately discontinue the use of the firearm and contact INTRATEC to report malfunction and return for service.

## WARRANTY

Failure to return the enclosed warranty card within 7 days will void the one year warranty on this product. This firearm is warranted against defects in materials and workmanship for one year to the initial purchaser only. During the warranty period, INTRATEC will repair or, at its option, replace at no charge components that prove to be defective, provided the gun is returned, shipping prepaid, to INTRATEC.

This warranty does not apply if your firearm has been damaged by accident or misuse, or after any service or modification by someone other than INTRATEC, INTRATEC shall not be liable for consequential damages. **NO OTHER WARRANTY, EXPRESS OR IMPLIED IS PROVIDED.**

## SERVICE

Should your firearm require adjustment, repair, or refinishing, we sincerely recommend that the weapon be returned unloaded to the factory. There is no other way to insure that the work will be done in a properly equipped and staffed shop. All returns must include the following information: Full Name, Street Address, City, State, Zip Code and Phone # (No P.O. Boxes). No gun will be accepted for repair if not complete, or if received loaded.

## NON-WARRANTY

Charges are very reasonable, being based on the cost of parts replaced plus a labor charge for the time spent on the job. **A letter of instruction must be enclosed with the gun**, and shipment by individuals must be made prepaid, properly packaged, via U.P.S. Adherence to these suggestions will prevent loss of time in handling at the factory.

When your firearm arrives for service, it will be carefully inspected, together with your letter of instructions. Next, a quotation covering the total cost will be sent to you. No actual work will commence before receiving your approval of our quotation.

## CARE AND CLEANING

To ensure proper functioning, the firearm should be disassembled and cleaned at reasonably frequent intervals, preferably always after shooting.

Use any good commercial solvent, and after cleaning, lubricate sparingly with a light weight gun oil. Outside surfaces may be protected from corrosion by coating lightly with rust inhibiting oil or grease. Be careful not to drop magazines, as they may be sufficiently deformed to cause malfunctions. Always keep ammunition away from gun during cleaning.



# TEC-DC9

## "SHOWN"

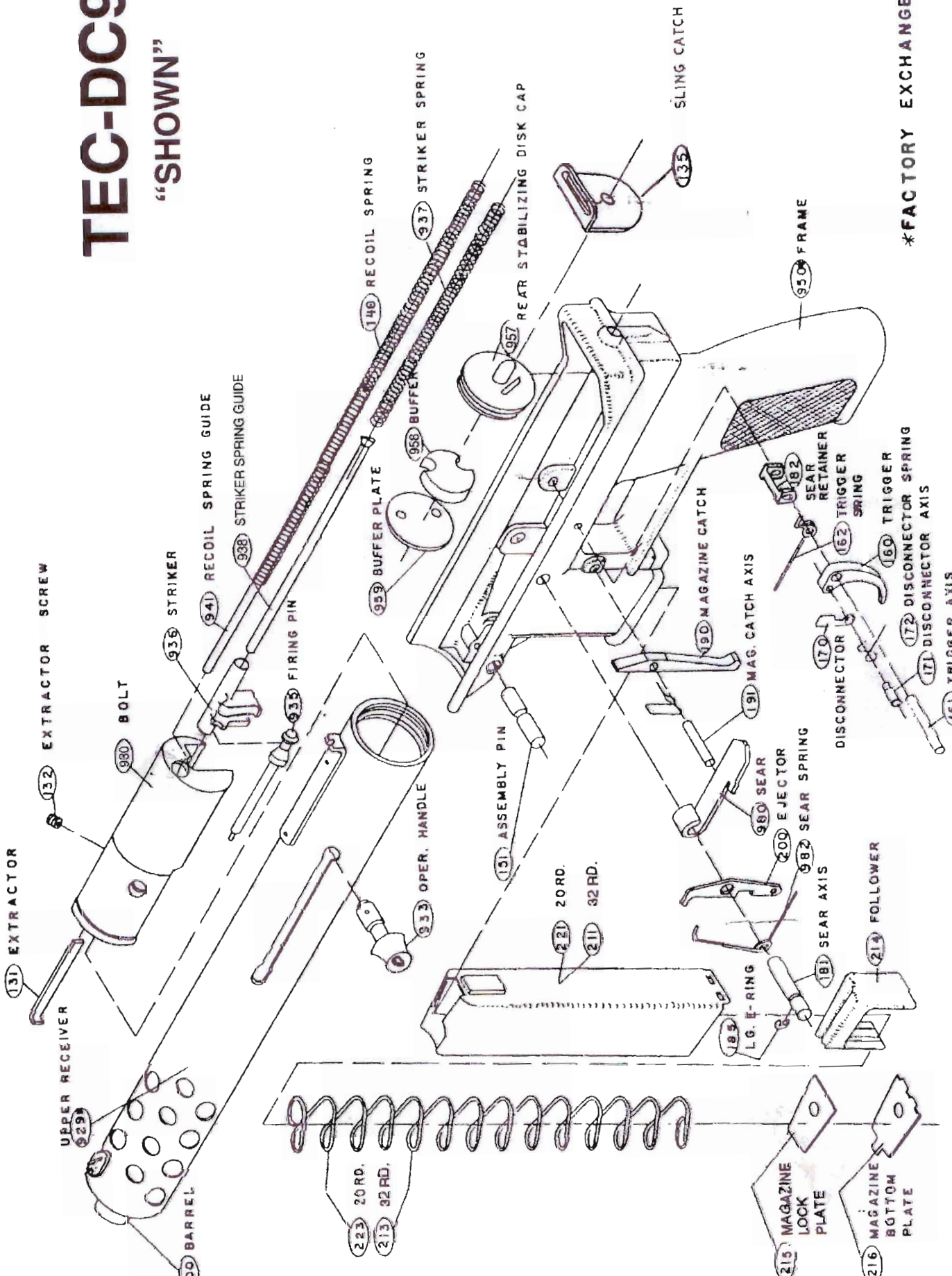

\*FACTORY EXCHANGE ONL

# TEC-DC9 & AB-10 PARTS LIST

**Please note:** That on the AB-10 Series the barrel is non-threaded and the upper receiver has no ventilatilation holes.

|                                |                                     |
|--------------------------------|-------------------------------------|
| 131 - Extractor                | 214 - Magazine follower             |
| 132 - Extractor screw          | 215 - Magazine lock plate           |
| 135 - Sling catch **           | 216 - Magazine bottom plate         |
| 140 - Recoil spring            | 221 - Magazine body (20 Rd.)        |
| 151 - Assembly pin             | 223 - Magazine spring (20 Rd.)      |
| *160 - Trigger                 | * 900 - Barrel                      |
| 161 - Trigger axis             | * 929 - Upper receiver sub-assembly |
| 162 - Trigger spring           | * 930 - Bolt                        |
| *170 - Disconnecter            | 933 - Operating handle              |
| 171 - Disconnecter axis        | 935 - Firing pin                    |
| 172 - Disconnecter spring      | * 936 - Striker                     |
| 181 - Sear axis                | 937 - Striker spring                |
| 183 - Sear retainer            | 938 - Striker spring guide          |
| 185 - E-ring (large)           | 941 - Recoil spring guide           |
| 190 - Magazine catch           | * 950 - Frame                       |
| 191 - Magazine catch axis      | 957 - Rear stabilizer disc cap      |
| 192 - Magazine catch spring    | 958 - Buffer                        |
| 200 - Ejector                  | 959 - Buffer Plate                  |
| 211 - Magazine body (32 Rd.)   | * 980 - Sear                        |
| 213 - Magazine spring (32-Rd.) | 982 - Sear spring                   |

\*Factory installed only.

For TEC-DC9, TEC-DC9M and AB-10 parts add prefix 160 and part number above.

For TEC-DC9S, TEC-DC9MS and AB-10S stainless parts add prefix 165 and part number above.

For TEC-DC9K and TEC-DC9MK kote parts add prefix 162 to part number above.

## **WHEN ORDERING PARTS PLEASE USE PART NUMBERS AND FULL DESCRIPTION**

### **WARNING:**

**Improperly fitted part may cause dangerous malfunction, damage to the firearm or personal injury to the shooter. It is the purchaser's responsibility to have all replacement parts correctly fitted and installed.**

Care has been taken in the preparation of this manual, however, INTRATEC is not responsible for typographical errors and omission contained herein.

\*\*New 135 Sling catch comes standard with all DC9 models after serial # D036673, and all AB-10 models for safer handling while in sling use.



 **INTRATEC**  
**FIREARMS**

12405 S.W. 130th St.

Miami, FL 33186-6224

Fax: (305) 253-7207

Phone: 305-232-1821

PR 11/97